

Dimensions Part-turn gearboxes with base and lever

Flange for mounting multi-turn actuator
EN ISO 5210/DIN 3210

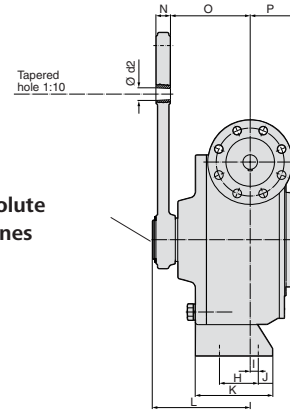
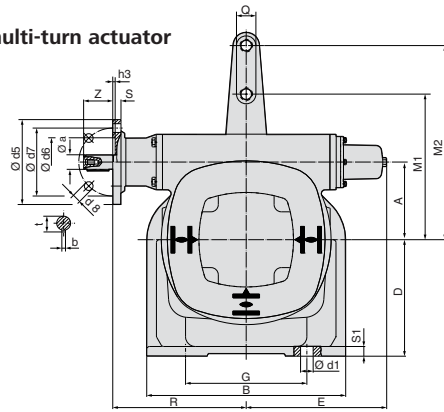

Involute splines

GS with primary reduction gearings

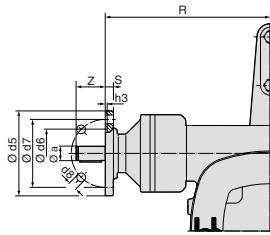

Ball joint

Only upon specific order

Suitable tube EN 10220

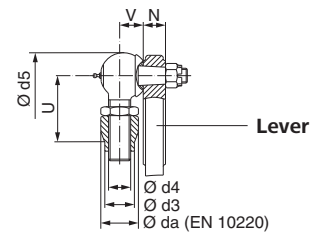

Lever

Versions

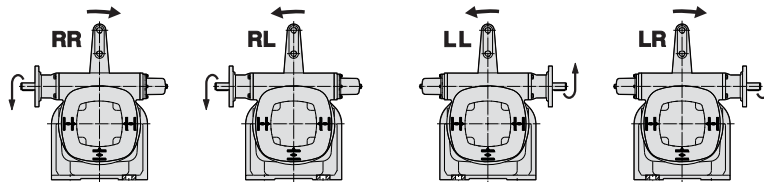

Dimensions	GS 160.3				GS 200.3				GS 250.3					
	54:1	218:1	442:1	53:1	214:1	434:1	864:1 1752:1	52:1	210:1	411:1	848:1			
A		160				200				250				
B		410				510				630				
D		240				300				380				
E		290				367				402				
G		250				320				400				
H		80				95				125				
I		17				24				42				
J		30				35				45				
K		160				200				260				
L		202				232				295				
M1		300				500				600				
M2		400				650				800				
N h11		30				34				42				
O		164				189				244				
P		95				115				140				
Q		40				50				60				
R	275	340	340	340	425	425	470	400	480	480	525			
S1		20				25				30				
U min.		85				95				110				
V		32				36				42				
Z	60	40	60	40	80	60	40	40	100	60	80	60	40	60
Ø a f7	30	20	30	20	40	30	20	20	50	30	40	30	20	30
b	8	6	8	6	12	8	6	6	14	8	12	8	6	8
Ø da EN 10220		48,3 x 4,0				48,3 x 4,0				60,3 x 5,0				
Ø d1		26				33				33				
Ø d2 H8		26				30				38				
Ø d3		40				40				50				
Ø d4		M30 x 1.5				M30 x 1.5				M38 x 1.5				
Ø d5		62				69				85				
t	33	22.5	33	22,5	43	33	22.5	22.5	53.5	33	43	33	22.5	33
Flange for mounting multi-turn actuator														
EN ISO 5210	F10								F14		F25			
DIN 3210					G0				G1/2					
Ø d5	125				125				175		300			
Ø d6	70				60				100		200			
Ø d7	102				102				140		254			
Ø d8	11				11				18		18			
h3	5				5				5		6			
s	12				12				17		25			

We reserve the right to alter data according to improvements made. Previous documents become invalid with the issue of this document.