

Spare parts list
auma[®]
Multi-turn gearboxes
GST 25.1 – GST 40.1

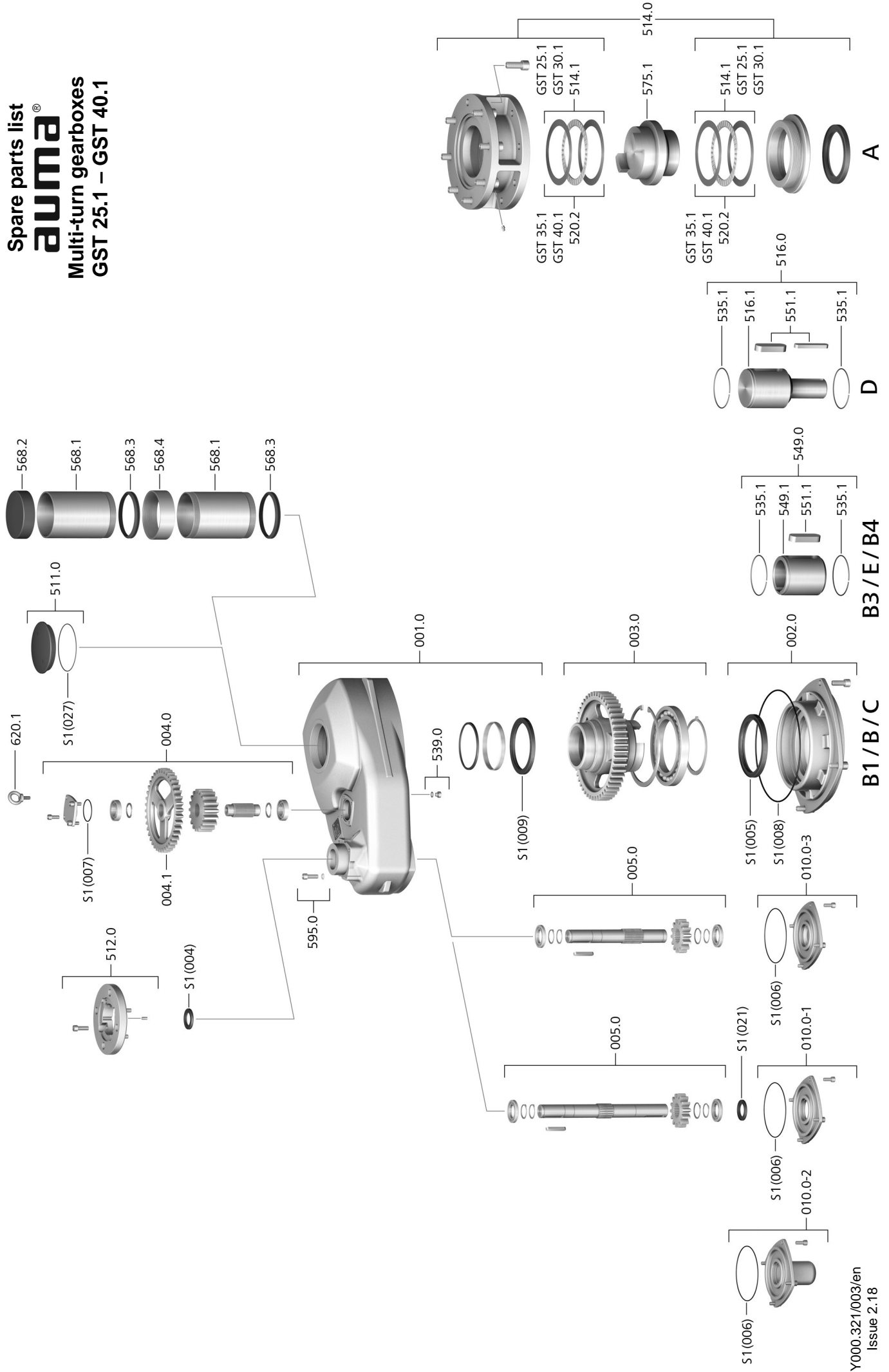

Spare parts list Multi-turn gearboxes

Please state device type and our order number (see name plate) when ordering spare parts. Only original AUMA spare parts should be used. Failure to use original spare parts voids the warranty and exempts AUMA from any liability. Representation of spare parts may slightly vary from actual delivery.

Ref. no.	Designation	Type
001.0	Housing	Sub-assembly
002.0	Bearing flange	Sub-assembly
003.0	Hollow shaft	Sub-assembly
004.0	Intermediate stage	Sub-assembly
004.1	Intermediate wheel	Sub-assembly
005.0	Input shaft	Sub-assembly
010.0–1	Bearing cover for second shaft end	Sub-assembly
010.0–2	Protection cover for second shaft end	Sub-assembly
010.0–3	Bearing cover	Sub-assembly
511.0	Threaded plug	Sub-assembly
512.0	Input mounting flange	Sub-assembly
514.0	Output drive type A (without stem nut)	Sub-assembly
514.1	Axial needle roller bearing	Sub-assembly
516.0	Output drive type D	Sub-assembly
516.1	Output drive shaft D	
520.2	Axial cylinder roller bearing (from GST 35.1)	Sub-assembly
535.1	Snap ring	
539.0	Screw plug	Sub-assembly
549.0	Output drive type B3/E/B4	Sub-assembly
549.1	Output drive sleeve B3/E/B4	
551.1	Parallel key	
568.1	Stem protection tube (without cap)	
568.2	Protective cap for stem protection tube	
568.3	V-seal	
568.4	Threaded sleeve	
575.1	Stem nut (without thread)	
595.0	Screw kit for manual gearbox	Sub-assembly
620.1	Eyebolt	
S1	Seal kit	Set