

Spare parts list
auma[®]
 PROFOX
 PF-M25 – PF-M100

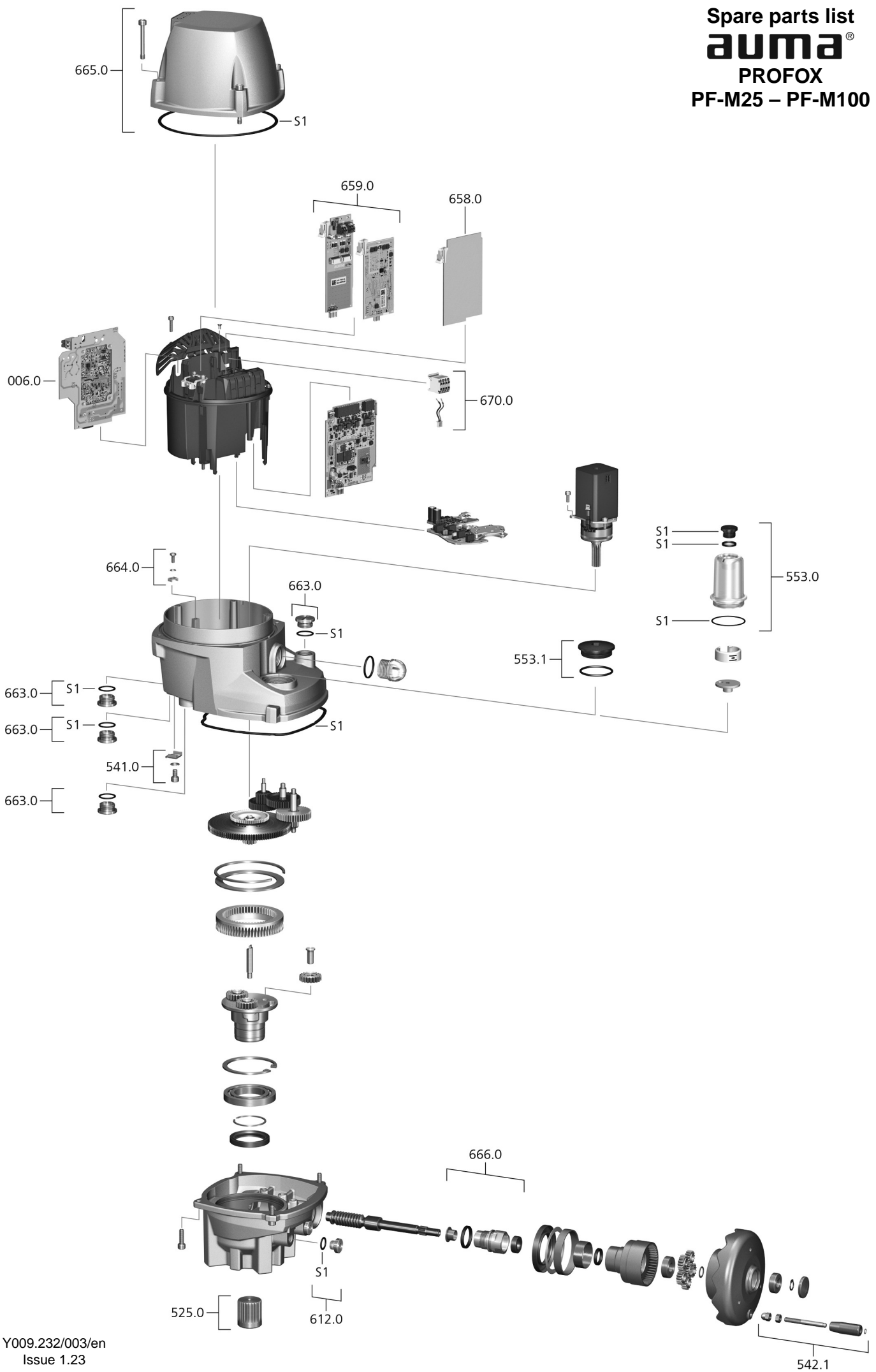

Spare parts list PROFOX

Please state device type and our order number (see name plate) when ordering spare parts. Only original AUMA spare parts should be used. Failure to use original spare parts voids the warranty and exempts AUMA from any liability. Only the designated spare parts with reference numbers or spare parts sets for replacement are available for the customer. The are specified in the following list. The parts shown in the exploded view without reference numbers may only be replaced by AUMA. Representation of spare parts may slightly vary from actual delivery.

Ref. no.	Designation	Type
006.0	Power supply unit	
525.0	Coupling	
541.0	Earth connection	Sub-assembly
542.1	Ball handle	Sub-assembly
553.0	Mechanical position indicator ¹⁾	Sub-assembly
553.1	Screw plug M40	Sub-assembly
612.0	Screw plug for end stop	Sub-assembly
658.0	I/O board as option	
659.0	Fieldbus boards (fieldbus and connection board)	Sub-assembly
663.0	Screw plug for manual emergency operation ²⁾	Sub-assembly
663.0	Screw plug for cable gland	Sub-assembly
664.0	Protective earth connection	Sub-assembly
665.0	Cover for electronics housing	Sub-assembly
666.0	Handwheel bearing flange	Sub-assembly
670.0	Auxiliary voltage output 24 V DC	Sub-assembly
S1	Seal kit	Set

- 1) A special tool is required for disassembly/assembly of mechanical position indicator. This can be ordered from AUMA (parts number: V004.027-02).
- 2) The manual emergency operation is only available for models PF-M5 and PF-M10, which are not equipped with a handwheel.