

Spare parts list
auma[®]
 Electrical connections (bent)
 for actuators
 SGM 04.1 – SGM 14.1
 SVM 05.1 – SVM 07.5
 Fieldbus

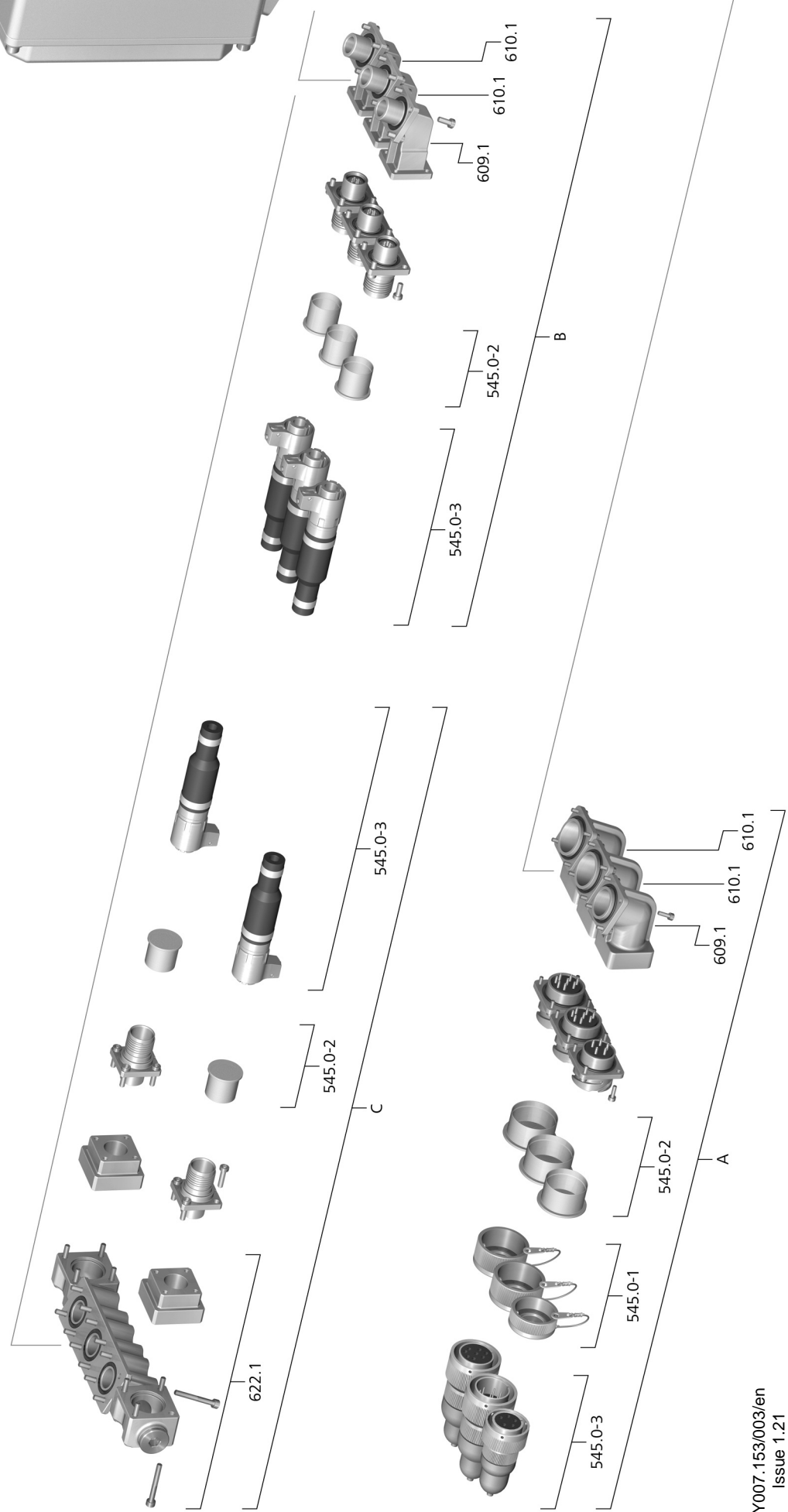

Spare parts list Electrical connections (bent) for actuators Fieldbus

Please state device type and our order number (see name plate) when ordering spare parts. Only original AUMA spare parts should be used. Failure to use original spare parts voids the warranty and exempts AUMA from any liability. Representation of spare parts may slightly vary from actual delivery.

Variants:

- A:** Electrical connection type CANNON (bayonet connector)
- B:** Electrical connection type JOWO (screw-type connector, welded and sealed)
- C:** Electrical connection type JOWO with flange plate (screw-type connector, welded and sealed)

Ref. no.	Designation	Type
545.0-1	Protective cap with cord	Sub-assembly
545.0-2	Protective cap without cord	Sub-assembly
545.0-3	Mating plug	Sub-assembly
609.1	Angle adapter for mains cables	Sub-assembly
610.1	Angle adapter for control contacts	Sub-assembly