

Spare parts list
auma®
 Globe valve actuators
 SVM 05.1 – SVM 07.5
 SVMR 05.1 – SVMR 07.5

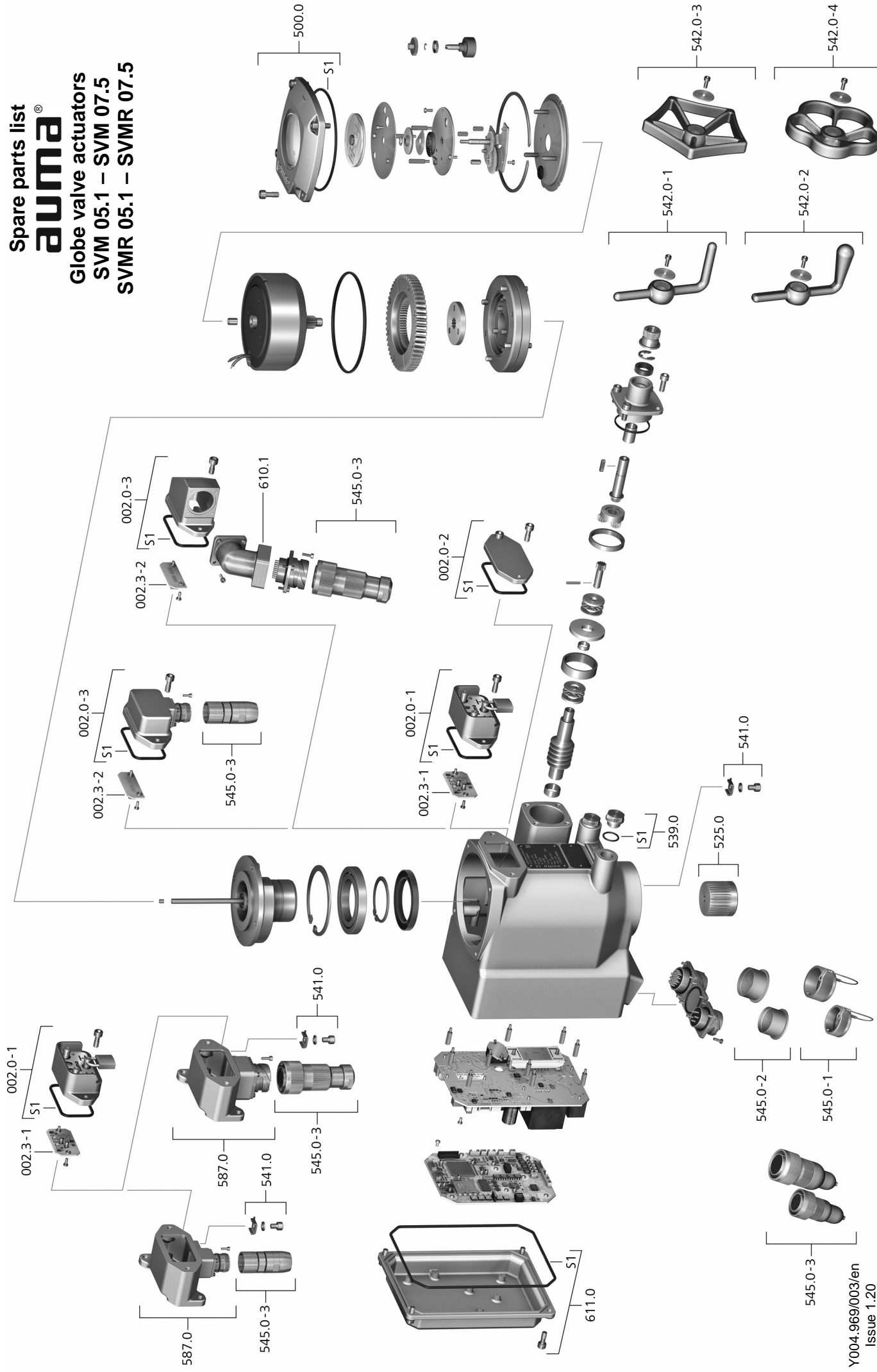

Spare parts list Globe valve actuators

Please state device type and our order number (see name plate) when ordering spare parts. Only original AUMA spare parts should be used. Failure to use original spare parts voids the warranty and exempts AUMA from any liability. Representation of spare parts may slightly vary from actual delivery.

Ref. no.	Designation	Type
002.0-1	Local controls	Sub-assembly
002.0-2	Cover (for version without local controls)	Sub-assembly
002.0-3	Cover with socket for connecting separately mounted local controls	Sub-assembly
002.3-1	Local controls board for 022.0-1	Sub-assembly
002.3-2	Board in connecting cover for 022.0-3	Sub-assembly
500.0	Cover	Sub-assembly
525.0	Coupling	Sub-assembly
539.0	Screw plug	
541.0	Protective earthing	Sub-assembly
542.0-1	Crank handle with cylindrical grip	Sub-assembly
542.0-2	Crank handle with conical grip	Sub-assembly
542.0-3	Handwheel with five-edge ring	Sub-assembly
542.0-4	Handwheel with five-ripple ring	Sub-assembly
545.0-1	Protective cap with cord	Sub-assembly
545.0-2	Protective cap without cord	Sub-assembly
545.0-3	Mating plug	Sub-assembly
587.0	Wall bracket	
610.1	Angle adapter for pins for controls	Sub-assembly
611.0	Cover	Sub-assembly
S1	Seal kit, small	Set