

Spare parts list
AUMA[®]
 Multi-turn actuators
 SA(V)Ex 07.2-UW – 16.2-UW
 SAR(V)Ex 07.2-UW – 16.2-UW
 AUMA NORM

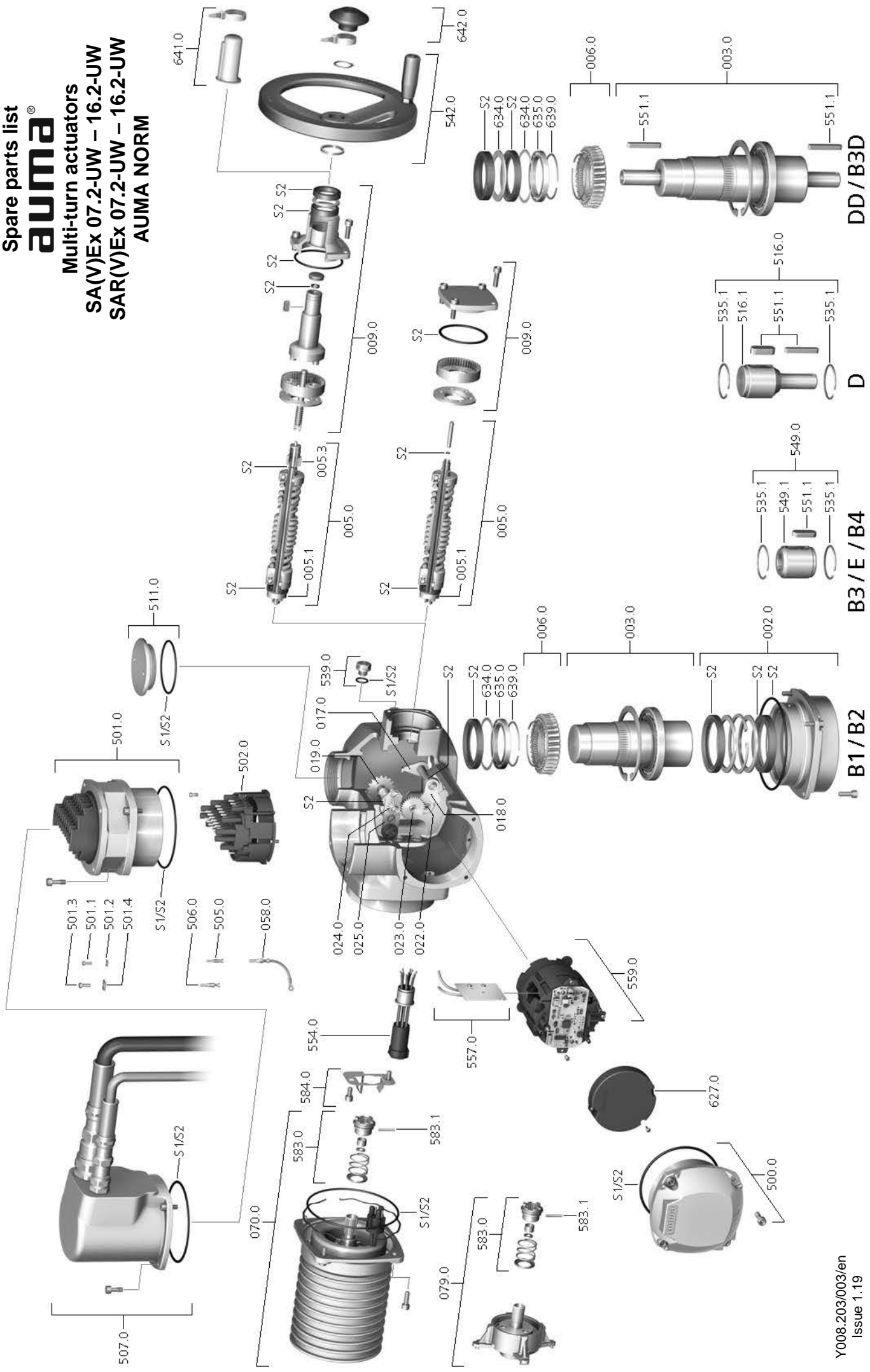

Spare parts list Multi-turn actuators AUMA NORM

Please state device type and our order number (see name plate) when ordering spare parts. Only original AUMA spare parts should be used. Failure to use original spare parts voids the warranty and exempts AUMA from any liability. Representation of spare parts may slightly vary from actual delivery.

Ref. no.	Designation	Type	Ref. no.	Designation	Type
002.0	Bearing flange	Sub-assembly	506.0	Pin for motor	Sub-assembly
003.0	Solid shaft B1/B2/DD/B3D	Sub-assembly	507.0	Cover for electrical connection	Sub-assembly
005.0	Drive shaft	Sub-assembly	511.0	Threaded plug	Sub-assembly
005.1	Motor coupling		516.0	Output drive type D	Sub-assembly
006.0	Worm wheel		516.1	Output drive shaft D	
009.0	Manual gearing	Sub-assembly	535.1	Snap ring	
017.0	Torque lever	Sub-assembly	539.0	Screw plug	Sub-assembly
018.0	Gear segment		542.0	Handwheel with ball handle	Sub-assembly
019.0	Crown wheel		549.0	Output drive type B3/E/B4	Sub-assembly
022.0	Drive pinion II for torque switching	Sub-assembly	549.1	Output drive sleeve B3/E/B4	Sub-assembly
023.0	Output drive wheel for limit switching	Sub-assembly	551.1	Parallel key	
024.0	Drive wheel for limit switching	Sub-assembly	554.0	Socket carrier for motor plug/socket connect- or with cable harness	Sub-assembly
025.0	Locking plate	Sub-assembly	557.0	Heater	
058.0	Cable for protective earth	Sub-assembly	559.0	Electronic control unit with magnetic limit and torque transmitter (MWG)	Sub-assembly
070.0	Motor (only for V... motors incl. ref. no. 079.0)	Sub-assembly	583.0	Motor coupling on motor shaft	Sub-assembly
079.0	Planetary gearing for motor drive (only for V... motors)	Sub-assembly	583.1	Pin for motor coupling	
500.0	Cover	Sub-assembly	584.0	Retaining spring for motor coupling	Sub-assembly
501.0	Socket carrier (complete with sockets)	Sub-assembly	627.0	MWG 05.03 cover	
501.1	Screw for control terminal		634.0	Shim washer (size 16.2 only)	
501.2	Washer for control terminal		635.0	Ball bearing	
501.3	Screw for power terminal		639.0	Retaining ring (size 16.2 only)	
501.4	Washer for power terminal		641.0	Shaft protection assy	
502.0	Pin carrier without pins	Sub-assembly	642.0	Bellows assy	
504.0	Socket for motor	Sub-assembly	S1	Seal kit, small	Set
505.0	Pin for controls	Sub-assembly	S2	Seal kit, large	Set