

Spare parts list
auma[®]
 Part-turn gearboxes
 GQB 80.1 – GQB 125.1

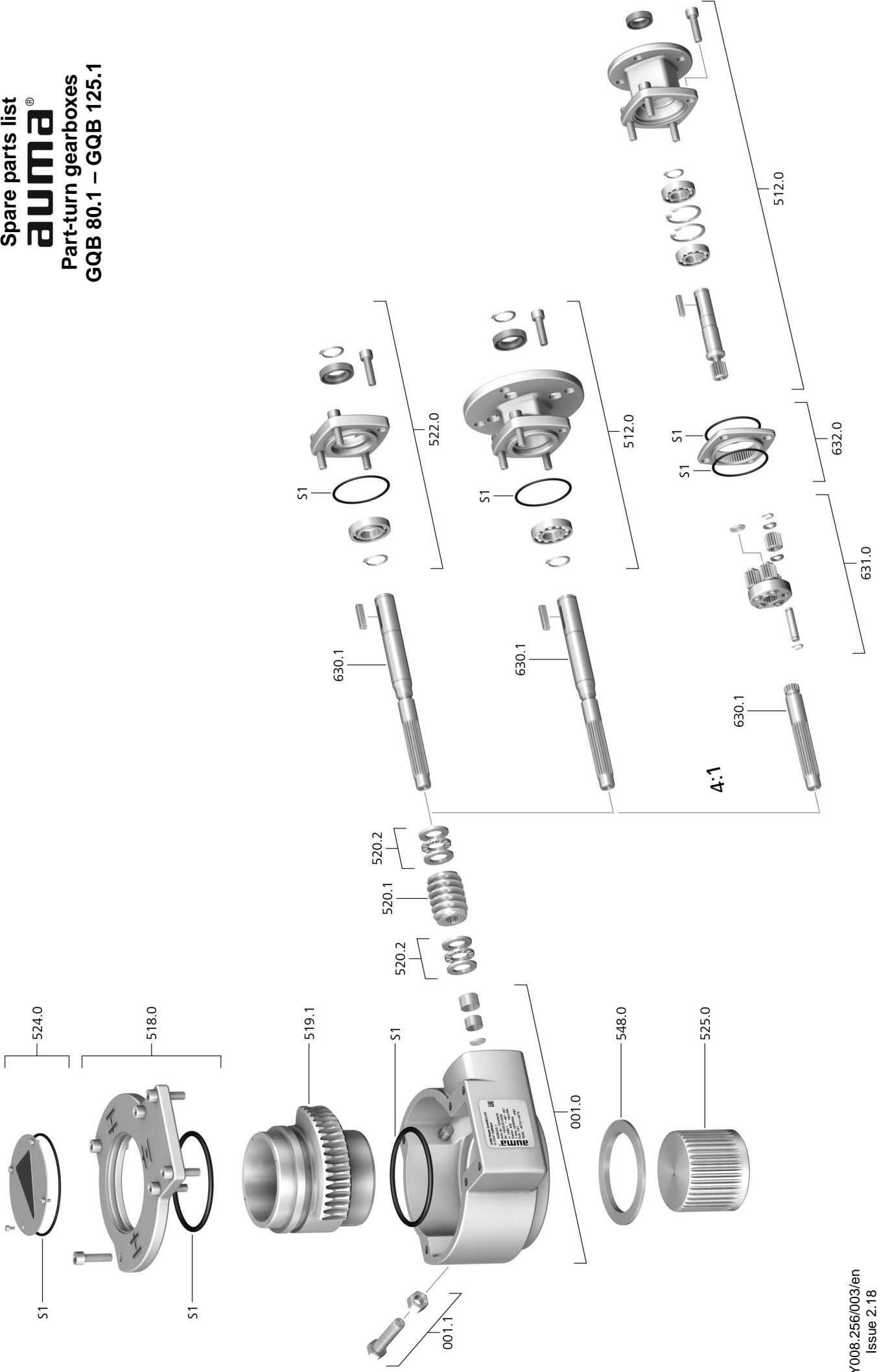

Spare parts list Part-turn gearboxes

Please state device type and our order number (see name plate) when ordering spare parts. Only original AUMA spare parts should be used. Failure to use original spare parts voids the warranty and exempts AUMA from any liability. Representation of spare parts may slightly vary from actual delivery.

Ref. no.	Designation	Type
001.0	Housing	Sub-assembly
001.1	Setting screw for end stop	Sub-assembly
512.0	Input mounting flange	Sub-assembly
518.0	Housing cover	Sub-assembly
519.1	Worm wheel	
520.1	Worm shaft	Sub-assembly
520.2	Axial cylinder roller bearing	
522.0	Bearing cover	Sub-assembly
524.0	Pointer cover	Sub-assembly
525.0	Coupling	Sub-assembly
548.0	Spigot ring	
630.1	Shaft	Sub-assembly
631.0	Planet carrier	
632.0	Internal geared wheel	
S1	Seal kit	Set